

Dual Concentric Knobs

Instrument Knobs



Industrial

Rotary
Switches

Military

Concentric Knob Systems



#1 - Soft Touch Collets; 15/21mm (for shaft type 1)

Inner shaft	Cap	15mm black	K51-C150-01
	Knob	15mm, soft touch, collet	K60-S150-004
Outer shaft	Knob	21mm, soft touch, collet	K60-S210-006



#2 - Classic Collets; 10/14.5mm (for shaft type 2)

Inner shaft	Cap	10mm black, glossy	040-1020
	Knob	10mm black, glossy	020-2120
Outer shaft	Knob	14.5mm black, glossy	020-3420



#3 - Metal Knobs; 11/15mm (for shaft type 1)

Inner shaft	11mm, metal
Outer shaft	15mm, metal
2pc Set	Numbers
Silver	AL-CON-SI (CAE041559)
Black	AL-CON-BK (CAE041560)

Metal Knob Dimension

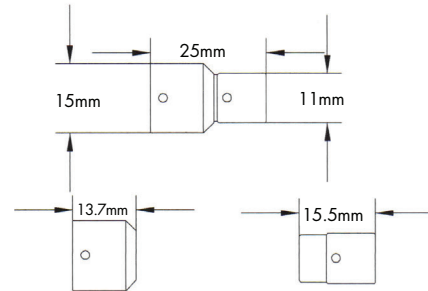

Recommended Encoders

E37 -

Orientation/Mounting

V - THT vertical
C - THT horizontal

Bushing

T - Threaded M7 x 0.75 x 6mm
(nut supplied, packed separately)
N - Non-threaded Ø 7 x 6mm

Push-Button

6 - 6 N
0 - Without push-button

Inner Shaft

(Resolution, Torque)*
3 - 16 detents (8 PPR) 2.5 Ncm
6 - 16 detents (16 PPR) 2.5 Ncm
8 - No detents (16 PPR)
9 - No detents (8 PPR)

Outer Shaft

1 - 32 detents (16 PPR) 2.0 Ncm
2 - 16 detents (8 PPR) 1.5 Ncm
3 - 16 detents (8 PPR) 2.5 Ncm
4 - 32 detents (8 PPR) 2.0 Ncm
5 - 16 detents (16 PPR) 1.5 Ncm
6 - 16 detents (16 PPR) 2.5 Ncm
8 - No detents (16 PPR)
9 - No detents (8 PPR)
A - 32 detents (16 PPR) 0.5 Ncm
B - 32 detents (16 PPR) 1.0 Ncm**

IP Sealing

0 - IP60
1 - IP68* shaft sealing
2 - IP68* shaft/front-panel sealing
(non-threaded bushing gasket provides IP65, O-ring/gasket is mounted)

Shaft Type

1 - Basic type (see drawing)
2 - Inner shaft; Ø 3.0mm, same length as basic type

Ordering Information

Push Button	Inner Shaft	Outer Shaft	IP Sealing	THT Vertical (threaded bushing†)	THT Vertical (threaded bushing†)
Yes, 6N	16 detents (8 PPR) 2.5 Ncm	16 detents (8 PPR) 2.5 Ncm	IP60	E37-VT6330-1	E37-CT6330-1
			IP68	E37-VT6332-1	E37-CT6332-1
		32 detents (16 PPR) 2.0 Ncm	IP60	E37-VT6310-1	E37-CT6310-1
			IP68	E37-VT6312-1	E37-CT6312-1

*O-ring of IP65/IP68 shaft sealing may slightly increase switching torque.

**Available with non-threaded bushing only.

† Nut supplied.